

PLANNING & ENVIRONMENT ACT 1987  
LATROBE CITY COUNCIL

Endorsed by Council

Sheet 1 of 1 sheet(s)

Date: 25/08/2025

Leigh Shaw  
Council Delegate

All future dwellings north of the pipeline easement and east of George Albert Drive are to be constructed in accordance with construction category 2 AS3771:1989. All other future dwellings above the pipeline reserve are to be constructed in accordance with construction category 1 AS3671:1989.

APA City Gate Facility  
Provide a connection to Gippsland Rail Trail and carpark area off Burnets Road to the satisfaction of the responsible authority.

3m high acoustic barrier/berm in accordance with recommendations of Acoustic Engineering Report by DDEG

LAND BUDGET			
DEVELOPMENT PLAN AREA	59.78ha		
OPEN SPACE	AREA	% SITE	
PROPOSED OPEN SPACE	10.11ha	16.91%	
PIPELINE EASEMENT	3.60ha	6.03%	
EXISTING DRAINAGE RESERVES	4.83ha	8.08%	
TOTAL	18.54ha	31.02%	
NET DEVELOPABLE AREA	41.24ha		
LAND USES		% NET DEV. AREA	
LOCAL ROADS	12.07ha	29.27%	
RESIDENTIAL LOTS <500m²	0.56ha	1.37%	
RESIDENTIAL LOTS 500- 900m²	20.40ha	49.47%	
RESIDENTIAL LOTS > 900m²	8.21ha	19.90%	
TOTAL AREA	41.24ha	100.00%	

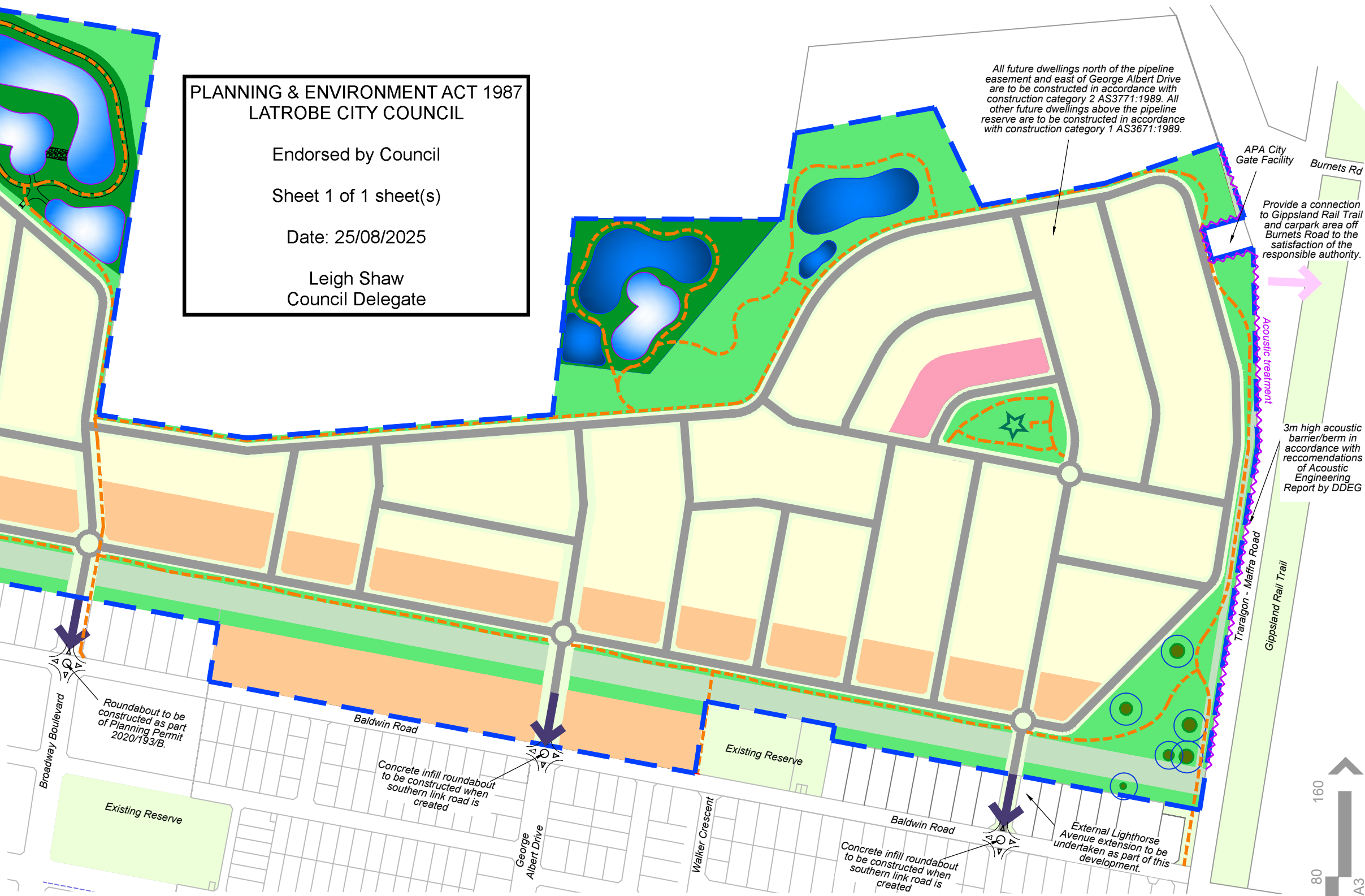

- Site Boundary
- Existing Water Sensitive Urban Design
- Proposed Water Sensitive Urban Design
- Pipeline Easement
- Play Space & Community Facility
- DPO11 Boundary
- Indigenous Tree to be Retained (with Tree Protection Zone)
- Indigenous Tree to be Removed
- Roundabout
- Road connection
- Shared Path Network
- External roundabout (Indicative)

FOR APPROVAL

Millar & Merrigan and the NBA Group authorise the use of this drawing only for the purpose described by the status stamp shown hereon. This drawing should be read in conjunction with all relevant contracts, specifications, reports and drawings. © Millar & Merrigan Pty. Ltd. and the NBA Group.