



# TRARALGON RECREATION RESERVE & SHOWGROUNDS MASTER PLAN UPDATE

Updated April 2020

# TABLE OF CONTENTS

Introduction	3
The project	5
Methodology and timelines	6
Reserve information	7
Design guidelines and principles	9
Stakeholder needs	11
<b>Master Plan</b>	
Introduction	14
Illustration	16
Implementation plan	17
Cost estimates	24

# ABOUT THIS DOCUMENT (PART A)

The Traralgon Recreation Reserve and Showgrounds Master Plan was originally developed in 2015 and has recently been updated to reflect the current needs of user groups and the local community. The Master Plan is delivered in two parts:

## Part A – The Master Plan

Provides a summary of master plan objectives, planning and design principles, updated stakeholder needs and consultation methods, and a revised master plan with strategic recommendations and cost estimates.

## Part B – Background Report

Provides project context, literature review and full site assessment and existing condition plans. Outcomes and key findings from stakeholder consultation undertaken in 2014 and other relevant data collected during the development of the original Master Plan is also provided in the Background Report.

The Traralgon Recreation Reserve and Showgrounds Master Plan was prepared by *insideEDGE* Sport and Leisure Planning (*insideEDGE*) on behalf of Latrobe City Council. This publication is Copyright©. No part may be reproduced, distributed or transmitted by any process of by any form except in accordance with the provisions of the Copyright Act 1968.

The information contained within this report is intended for the specific use of the within named party to which it is addressed (“the *insideEDGE* client”) only. All information and recommendations by *insideEDGE* are based on information provided by or on behalf of the *insideEDGE* client and *insideEDGE* has relied on such information being correct at the time this report was prepared.

**DRAFT**



# INTRODUCTION

The Traralgon Recreation Reserve and Showgrounds Master Plan was originally commissioned by Latrobe City Council in 2013 to establish a clear direction for the future planning and provision of sport and community infrastructure. The project was completed in 2015 and the Master Plan is now being updated to reflect the current needs and aspirations of tenants, local residents and casual users of the reserve.

Although the overall vision and use of the Traralgon Recreation Reserve has generally remained the same, project priorities and strategic recommendations have changed since 2015. These changes are reflected in this document and have been informed by recent engagement with key stakeholders and alignment with Council priorities.

The Traralgon Recreation Reserve and Showgrounds is defined in Council's Public Open Space Strategy as a 'Regional' reserve comprising of two sporting fields (main Traralgon Recreation Reserve Oval and Old Trafford Oval). The reserve hosts local sport, attracts regional sporting events and is home to the Traralgon and District Agricultural Show - coordinated by long term site tenants and part land owners, the Traralgon and District Agricultural Society.

Outside of organised sport and the Show, the reserve is also used frequently by local residents for passive recreation pursuits including walking, jogging, dog walking and community gatherings.

With a mixture of land ownership arrangements and a variety of community and recreation user groups, the site's complex nature and usage requirements has seen the establishment of a Council endorsed Advisory Committee. This Committee provides advice to Council on the operation of the reserve and assists with the ongoing management of community facilities.

Situated in the Traralgon flood plain, the reserve has both a flood overlay and a land subject to inundation overlay applied over approximately 95% of the site. These overlays, along with a number of other site constraints, have been considered when developing master plan recommendations. It is important to note that several projects recommended will require further investigation, consultation and approval from the West Gippsland Water Catchment Management Authority.

To improve overall reserve capacity and participation opportunities, the master plan aims to enhance the quality and accessibility of sport and community infrastructure. It also seeks to better connect facilities, user groups and the wider Traralgon community.

The development and update of the Traralgon Recreation Reserve and Showgrounds Master Plan included considerable community and stakeholder consultation. The outcomes of the consultation process has ensured that recommendations reflect current and future community needs, as well as meeting best practice and peak sporting body facility development guidelines.

The general themes from the consultation process related to the condition, functionality and connectivity of reserve infrastructure.

These themes have informed the development of strategic recommendations and improvement priorities that will guide the future planning and development of the Traralgon Recreation Reserve. The key focus areas for reserve improvements include:

- Improving site access.
- Replacing or renewing aged and dysfunctional buildings.
- Provision of high quality sport and event infrastructure
- Traffic management
- Provision of informal recreation opportunities
- Effective and efficient site management

Stakeholder and community input into the future direction and role of the Traralgon Recreation Reserve and Showgrounds has created the following reserve vision.

*'A multi-use open space venue that provides opportunities for organised sport, regional and community events and informal activities, whilst recognising and retaining the site's strong historical and cultural significance.'*



**DRAFT**

Since the completion of the original 2015 Traralgon Recreation Reserve and Showgrounds Master Plan a number of key projects have been delivered. Funding for these projects were provided by Council and a range of partners including Federal and State Government, Latrobe Valley Authority and local sporting clubs.

- Construction of TEDAS sporting pavilion.
- 300 lux sports field lighting to main oval to Australian Standards for night cricket.
- New floodlit acrylic netball court.
- Upgrade and provision of unisex change rooms in main pavilion.
- New electronic scoreboard

**Other projects identified in the 2015 Master Plan that remain a priority include:**

- Old Trafford Oval ground resurfacing, expansion and lighting upgrade works.
- New accessible public play space and picnic area.
- Provision of an additional netball court including shelters and court lighting.
- Relocate the existing BMX track to a more suitable site and enhance passive open space opportunities.
- Expand the existing shared trail network and improve pedestrian safety across the reserve.
- Extend and upgrade existing amenities to cater for sport and community events.
- Upgrade and expand car parking surrounding oval.
- Replace reserve perimeter fencing with uniformed fencing and improve pedestrian access.

# THE PROJECT

## BACKGROUND AND CONTEXT

The 2015 Traralgon Recreation Reserve and Showgrounds Master Plan was developed to support the implementation of Council's 2006 Recreation Plan. The intent of the Master Plan was to provide clear direction for the future planning, provision and enhancement of sport and community infrastructure at Traralgon Recreation Reserve and Showgrounds.

Traralgon has a forecast population of approximately 34,500 by 2031 (32% increase on 2011). To service this growth a coordinated approach to the future planning, development and implementation of recreation services and associated sporting and community infrastructure at Traralgon's premier sporting precinct is required.

## PROJECT OBJECTIVES

The key objectives of the 2015 Traralgon Recreation Reserve and Showgrounds Master Plan were to:

- Identify reserve development opportunities for the Traralgon and surrounding communities for the next 10 years.
- Optimise sports facility and open space usage and increase multi-use and efficiency of recreational facilities.
- Provide a prioritised implementation plan, including cost estimates for master plan infrastructure recommendations.
- Provide advice on a sustainable management structure ensuring equitable access, usage and funding is provided to clubs and associations.

## DESIGN & DEVELOPMENT PRINCIPLES

To support the delivery of Master Plan recommendations the following design guidelines and development principles were adopted by Latrobe City Council.

The five key themes that underpinned the design guidelines, development principles and eventual reserve improvement recommendations include:

1. Future facility development.
2. Accessibility.
3. Community infrastructure and social amenity.
4. Sports field provision and suitability.
5. Reserve and facility management.

*The process for reviewing and updating the Traralgon Recreation Reserve and Showgrounds Master Plan commenced at the start of 2020. Meetings with sport and community user groups located at the reserve, and consultation with relevant peak sporting bodies, has informed the updated Master Plan.*

# METHODOLOGY & TIMELINES

THE 2015 TRARALGON RECREATION RESERVE AND SHOWGROUNDS MASTER PLAN WAS UNDERTAKEN IN FIVE KEY STAGES COMMENCING IN AUGUST 2013.

THE REVIEW OF THE MASTER PLAN WAS COMPLETED IN APRIL 2020.

# DRAFT

August 2013 to March 2015

March /  
April  
2020

## STAGE 1 Project initiation

- Project commencement
- Site inspection



## STAGE 2 Situational & needs analysis

- Demographic review
- Literature review
- Mapping
- Sports participation demand
- Trends and influences



## STAGE 3 Stakeholder Engagement

- Stakeholder workshops
- Meetings and interviews
- Surveys



## STAGE 4 Draft Master Plan

- Key directions
- Master Plan options
- Cost estimates
- Presentation to Council Committees
- Stakeholder presentations



## STAGE 5 Final Master Plan

- Finalise reporting
- Finalise cost estimates
- Implementation schedule



## STAGE 6 Master Plan review

- Stakeholder engagement
- Update reporting
- Update Master Plan and cost estimates

# RESERVE INFORMATION

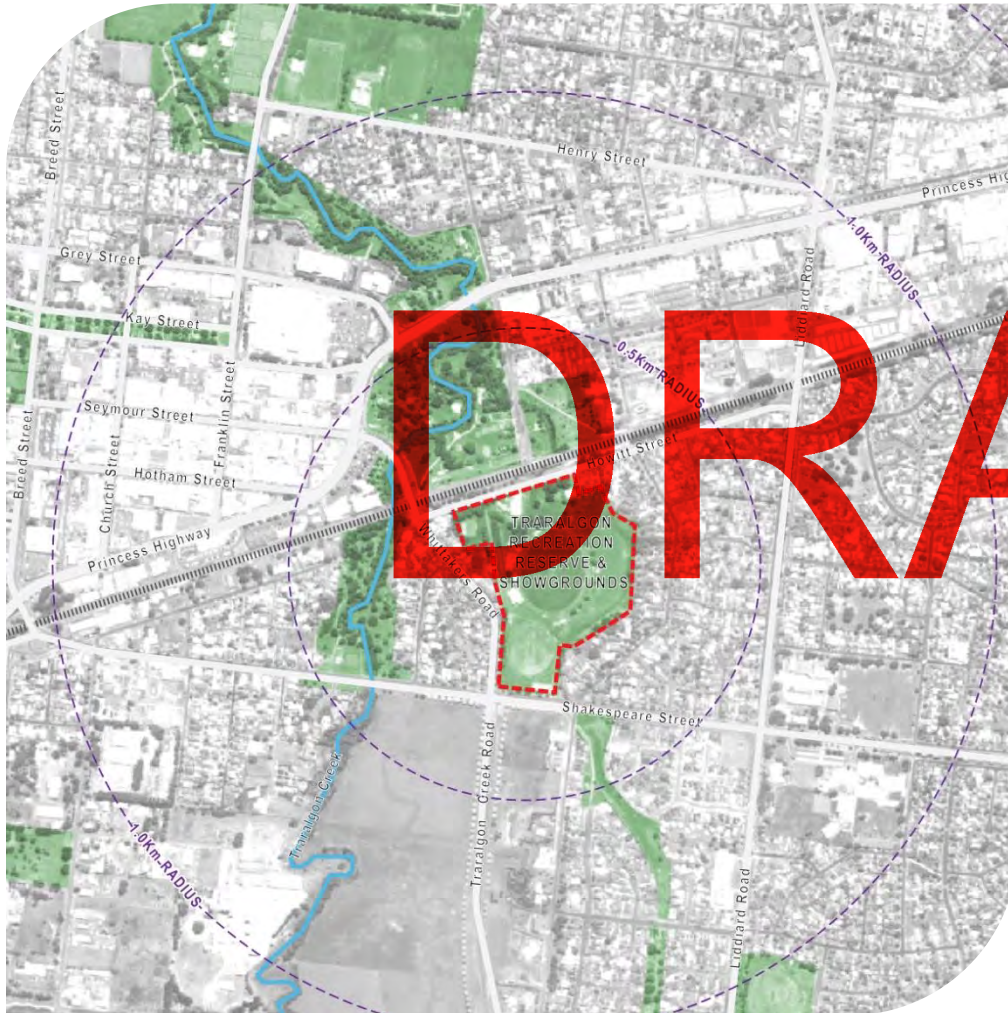

The adjacent aerial image of the Traralgon Recreation Reserve and Showgrounds site shows the master plan project study area (red outline).

The site includes the main Traralgon Recreation Reserve and Showgrounds sporting field and Old Trafford Oval (to the south), along with multiple sporting club and community user group buildings.

## PUBLIC OPEN SPACE STRATEGY 2013

**Reserve Hierarchy Classification:** Regional

**Primary Function:** Sport

**Level Of Use:** High

The Traralgon Recreation Reserve and Showgrounds site plays host to over a dozen regular tenants with participation recorded for the following organised sporting/community activities and events:

- AFL
- Netball
- Pigeon Racing
- Wood chopping/Woodwork
- Bridge
- Roller Derby
- Traralgon and District Agricultural Show
- Cricket
- Fire Brigade Competitions
- Boxing

## RESERVE USERS

- Traralgon and District Agricultural Society.
- Traralgon Urban Fire Brigade.
- Traralgon Men's Shed.
- Traralgon Bridge Club.
- Traralgon and District Pigeon Club.
- Traralgon Football Netball Club.
- TEDAS Junior Football Club.
- Ex Students Cricket Club.
- Traralgon Amateur Boxing Club.
- Traralgon Playgroup.
- South and Central Gippsland Axeman Association.
- Gippsland Superules League.
- Gippsland Roller Derby.

## EXISTING RESERVE INFRASTRUCTURE

- Two sporting fields (one full size and one junior).
- Main sporting field is floodlit to 300 lux with an electronic scoreboard
- Main pavilion/social rooms with unisex change rooms.
- Tony Lane Grandstand.
- TEDAS sports pavilion servicing Old Trafford Oval.
- One acrylic fully compliant netball court with lighting and one asphalt court.
- Temporary grandstand seating and netball storage/shelters.
- Multiple Traralgon and District Agricultural Society buildings.
- Fire brigade running track and associated building.
- Traralgon Bridge Club and Men's Shed buildings.
- Cricket training nets.
- Cricket storage shed.
- BMX Track.
- Public toilet blocks (2).

**DRAFT**

## KEY RESERVE ISSUES/CONSTRAINTS

- Site subject to flooding.
- Some aged and dysfunctional buildings not meeting sport or community expectations.
- A gap in the provision of amenities for netball.
- Limited capacity of Old Trafford Oval to provide adequately for sport and events.
- Uncoordinated traffic movement resulting in vehicle congestion.
- Inadequate car parking/lack of definitive car parking spaces.
- Unclear site management, communication and stakeholder responsibilities.

## VALUED RESERVE CHARACTERISTICS

- Site history and tradition.
- Centralised location.
- Large open space.
- Variety of facilities.
- Community atmosphere.

# PLANNING AND DESIGN GUIDELINES AND DEVELOPMENT PRINCIPLES

The following development principles have been used to guide the interpretation, consideration and preparation of design options for the Traralgon Recreation Reserve and Showgrounds Master Plan.

## 1. FUTURE FACILITY DEVELOPMENT

- 1.1 Replace redundant and functionally obsolete buildings and amenities with facilities that meet shared sport, community and education objectives.
- 1.2 The provision of recreation and leisure facilities shall maximise shared usage and flexibility to meet changing community needs and aspirations.
- 1.3 Support for tenants currently utilising separate buildings to consolidate into one building.
- 1.4 Priority shall be given to supporting the provision of sport and recreation facilities that cater for both municipal and local level needs.
- 1.5 Sport and recreation facilities shall provide safe and supportive environments for participants and an emphasis on the provision of new (unstructured) recreational pursuits and open space should be considered.
- 1.6 Universal, Healthy by Design, Female Friendly and Crime Prevention guidelines and principles will underpin the planning and design of future facility developments.

## 2. ACCESSIBILITY

- 2.1 Provide a diverse range of accessible recreation facilities and open space areas across the reserve to meet the needs of Latrobe's diverse community.
- 2.2 Ensure recreation reserves and supporting facilities are accessible, safe and appealing for people with a disability (Disability Discrimination Act compliance).
- 2.3 Ensure equitable provision of reserve infrastructure and supporting facilities according to age, gender, cultural background and ability.
- 2.4 Ensure reserve infrastructure and supporting facilities are safe and secure for older adults (security lighting, car park provision, access into and around facilities).
- 2.5 Improve and link bicycle paths, footpaths and road networks to encourage physical activity and promote liveability.
- 2.6 Continue to maintain and improve access to all reserves and open space areas.
- 2.7 Improve vehicle entry/egress and car parking provision at recreation reserves and open spaces to meet expected day-to-day usage and sporting/community event requirements.
- 2.8 Enhance connectivity between key sporting reserves and community infrastructure.
- 2.9 Provision of walking paths/tracks/trails that allow for both recreational opportunities and destination based routes.

### 3. COMMUNITY & SOCIAL AMENITY

- 3.1 Ensure reserve amenities and open space areas are available for informal recreation activities.
- 3.2 Facilitate increased passive recreational use of the reserve by providing informal recreation facilities (e.g. paths, seats, plantings, BBQ/picnic areas, playgrounds).
- 3.3 Develop and maintain community infrastructure that connects and meets the needs of the Latrobe community.
- 3.4 Promote and support opportunities for people to enhance their health and wellbeing through physical activity.
- 3.5 Enhance and develop the physical amenity and visual appearance of the reserve.
- 3.6 Continue to support event infrastructure to strengthen Latrobe's community well being and liveability.
- 3.7 Continue to build pride of place and recognise the historical significance of the reserve.
- 3.8 Enhance the visual amenity of the reserve through additional tree planting and landscaping.

### 4. SPORTS FIELD PROVISION & SUITABILITY

- 4.1 Continue to develop best practice reserve and supporting facilities/amenities that provide for emerging and high demand sports.
- 4.2 Promote and facilitate increased participation opportunities for target groups such as older adults, women and children via supporting reserve facilities and amenities.
- 4.3 Strengthen the capacity of sporting clubs and organisations seeking to improve the quality of reserve facilities.
- 4.4 Develop relationships with local schools to integrate management and use of school and public facilities.
- 4.5 Encourage and promote formalised sporting competitions, sports carnivals and elite training at the reserve.
- 4.6 Continue to ensure high levels of playing field provision and conditions are maintained to meet levels of training/competition requirements (e.g. sports field lighting).
- 4.7 Encourage shared use of sporting reserves, training facilities, building and amenities.
- 4.8 Identify opportunities to encourage increased use of existing fields before adding new playing areas.
- 4.9 Maintain dedicated playing field areas, ensure they are appropriately sized and dimensioned and maximise their use and flexibility for configuration and usage by additional sports or activities.
- 4.10 Minimise (where not mandatory) reserve fencing to allow for greater flexibility and shared usage.
- 4.11 Recognise and promote Traralgon Recreation Reserve as a regional venue with capacity to host high level sporting and community events.

DRAFT



# STAKEHOLDER NEEDS

A realistic and practical master plan which addresses the immediate needs of key stakeholders and responds to future sport and community demands requires significant consultation.

Key stakeholders consulted during the initial development and recent review of the master plan included Council staff, community user groups, local sporting clubs, leagues, associations, peak sporting bodies, government agencies and local community residents.

## CONSULTATION METHODS

The following consultation methods were undertaken to inform the development of the 2015 Traralgon Recreation Reserve and Showgrounds Master Plan.

- Meetings and presentations to Project Steering Group.
- One workshop with Latrobe City Council's Internal Reference Group.
- Councillor Briefing presentation.
- On-site presentations to key stakeholders.
- Individual meetings and interviews with reserve sporting/community user groups.
- One community meeting/workshop at Traralgon Recreation Reserve and Showgrounds.
- Written submissions from local residents.
- Two Project Bulletins.
- Online and hard copy organisation and general community member/resident reserve user surveys.
- Telephone interviews with key government agencies, peak sporting bodies and associations.
- Site visit/inspection.
- Project management design brief workshop.

- Opportunity for stakeholder groups to meet individually with Council officers to discuss Draft Master Plan and supporting Implementation Plan.

- Council's online 'Have your Say' promotion and encouragement of written submissions from stakeholders on Draft Master Plan.
- Final design workshop with Council officers, project consultants and landscape architects.

Meetings with the following user groups and stakeholders were undertaken in March 2020 to assist in reviewing and updating the Master Plan.

- TEDAS Junior Football Club
- Ex Students Cricket Club
- Gippsland Roller Derby
- Traralgon Bridge Club
- Traralgon Football Netball Club.
- Gippsland Masters Football Club
- Traralgon District Cricket Association
- Traralgon Playgroup
- Traralgon Agricultural Society
- Traralgon Urban Fire Brigade
- Peak sporting bodies (AFL, Cricket and Netball)

Reserve user groups were asked to provide an update on their current needs, facility development priorities and future aspirations for the updated Traralgon Recreation Reserve and Showgrounds Master Plan. A summary of responses are provided below.

#### **TEDAS Junior Football Club**

- Improve the condition, playability and size of Old Trafford Oval.
- Community events held on Old Trafford Oval heavily impacts the surface.
- Other priorities include upgrading change rooms to unisex, oval fencing, electronic scoreboard, coaches boxes and spectator seating.

#### **Ex Students Cricket Club**

- Sight screens on the main oval is the clubs highest priority. This will enable the club to utilise the field lighting and offer night cricket and regional events.
- Redeveloping Old Trafford Oval is required to meet senior cricket and junior football guidelines. Removal of old lighting infrastructure on main oval
- Fencing Old Trafford Oval to eliminate pedestrian walk through on competition days.
- Other priorities include improving cricket practice wickets with a soft net roof, increasing shade for spectators and electronic scoreboard on Old Trafford Oval.

#### **Gippsland Roller Derby**

- Three year lease with the Traralgon Agricultural Society and have secured external funds to refurbish their facility. The club have 100 members and 20 competitive skaters.
- Future project priorities include upgrade to female toilets (preference for gender neutral), full cladding of walls to make them vermin proof and replacing roof sheeting.
- The current access issues into the shed and security measures to address anti-social behavior also needs to be investigated.

#### **Traralgon Bridge Club**

- Shares the recently refurbished hall with a community health group, band group and weight loss group.
- Additional parking and disabled parking bays are a priority to support members with mobility issues. Improvement also required to the rear of the hall.

#### **Traralgon Football Netball Club**

- Enhancing netball amenities to provide change rooms, toilets, umpires and first aid room is the highest priority. A second netball court is also needed.
- Alternatively re-line marking and better floodlighting on the asphalt netball court would assist netball capacity.
- Increasing and improving spectator capacity and amenities to accommodate major events is required. Priorities include accessible public toilets, formalised car parking and amenities to service upstairs viewing room in the clubrooms.
- Support for the redevelopment of Old Trafford Oval and removal of old lighting infrastructure around the main oval.
- Longer term a full redevelopment of the building occupied by the football club is required.

#### **Traralgon Urban Fire Brigade**

- Utilise the Fire Track and CFA building over summer. The old asphalt netball court is also used for car parking.
- Additional car parking behind the Playgroup would assist Fire Brigade operations. Supportive of old toilet block being refurbished.
- Old Trafford Oval is the designated staging area in the event of a bushfire which needs to be accessed by heavy vehicles.

#### **Traralgon Agricultural Society**

- The Agricultural Society have been progressively upgrading their facility with the view of re-introducing the Traralgon Show back to the reserve. Installation of 3 phase power is a high priority.
- Plans in place to upgrade and activate the 'Craft Shed' including unisex toilet, full commercial kitchen and improvements to cladding and seal asbestos.
- Issues with security - CCTV surveillance needed as well as permanent lighting.
- Support for the upgrade of Old Trafford Oval and retaining it as a multi use sport, community and event space.
- Support for all abilities play space, disabled car parking and improving netball amenities.

### Traralgon Playgroup

- Vehicle access to the Playgroup is via the old netball court along the asphalt path to the beside the new netball court.
- A formalised car park and sealed path to the building is the highest priority.

### Gippsland Masters Football Club

- A social group who utilises the reserve in winter for one training session per week and 5 Sunday games per year.
- The club see an opportunity to use Old Trafford for training if the surface and lights were upgraded.

### Traralgon Recreation Reserve Committee (community member)

- The focus should be on the provision of high quality sporting infrastructure and investing in the upgrade of Old Trafford Oval to act as an overflow venue.
- Drainage at the reserve needs to be improved. The master plan provides an opportunity to identify where water flow and drainage could be improved.
- Support for netball amenities but these should be shared with other user groups.
- BMX track needs to be relocated.
- Issues with security and inadequate lighting.

### Community drop in sessions (local residents)

- Support for the Traralgon Show to return to the reserve and refurbishment of the 'Craft Building' to support this.
- Residents would like to see the reserve as a designated RV/Caravan parking area.
- The Rodeo which has previously been held on Old Trafford Oval is better suited to the Racecourse.
- The 'open drain' is not ascetically pleasing and back fences are being impacted due to the drain not being properly maintained.

### Cricket Victoria

- Supports the redevelopment of Old Trafford Oval to ensure the club has access to a suitable secondary venue to provide entry level programs and grow junior and female participation.
- There is limited demand for cricket events in Gippsland. Ted Summerton Reserve, being the regional cricket hub, is the preferred venue for hosting daytime premier cricket and BBL matches/
- The 300 lux lighting at Traralgon would only be suitable for hosting local community cricket and association level content. Premier cricket and above requires a minimum of 500 lux

### Netball Victoria

- There is an urgent need to provide new player and spectator amenities to service the netball court. These should ideally be located on the western side of the court and replace the existing amenities.
- The master plan should also identify additional covered spectator amenities (shelter) on the eastern side where the uncovered grandstand is currently located.
- Support for the development of a second court to provide additional training and development opportunities.

### AFL Gippsland

- AFL Gippsland were unable to be contacted for comment.

# MASTER PLAN

## RESERVE VISION

A multi-use open space venue that provides opportunities for organised sport, regional and community events and informal activities, whilst recognising and retaining the site's strong historical and cultural significance.

## RECOMMENDATIONS

This section of the report provides recommendations for the Traralgon Recreation Reserve.

Recommendations are designed to provide sport, government and community stakeholders with a schedule of prioritised improvements and upgrades. Each are supported by proposed stakeholder responsibilities, cost estimates and potential funding opportunities.

Ongoing ownership, monitoring and delivery of recommendations will require a planned approach from Council and project partners.

Recommendations focus on a 10 year timeframe, with several subject to further investigation and approvals.

## STAKEHOLDER RESPONSIBILITIES

Identifying stakeholder involvement and allocation of roles, responsibilities and resources provides a focused approach to delivery and implementation. Each master plan recommendation has been nominated a stakeholder responsible for the initiation, planning and funding of individual reserve recommendations.

## IMPLEMENTATION PLAN

Each master plan recommendation has been allocated a level of priority within the implementation plan. This is based on their relative impact on delivering project outcomes.

**HIGH:** Important recommendation that underpins the future delivery of sport and community infrastructure, open space and site management initiatives. High priority projects are considered to have the greatest potential of attracting external funding and require immediate planning to commence at the earliest opportunity.

**MEDIUM:** Recommendation that delivers on meeting the overall objectives of the Master Plan.

**LOW:** Recommendation that will contribute to the overall improvement of sport and community infrastructure at the reserve.

**It should be acknowledged that priorities can change and are based on funding availability. The presentation of new or unknown opportunities or changes in community demands can also alter priorities.**





# DRAFT

## OPINION OF PROBABLE COSTS

To assist Latrobe City Council and its strategic partners in the development of funding submissions, future capital works planning and general budget development, each individual reserve recommendation (with the exception of management related recommendations) has an 'opinion of probable cost'. Opinion of probable costs are estimated calculations based on current market trends, similar project costings and our professional consulting experience.

It should be noted that cost estimates exclude preliminaries, site establishment fees, builder's margin and services provision costs. Cost estimates for car parks, roads and related lighting are subject to further investigation and detailed design (it has been assumed re-sheeting over existing car parks is all that is required rather than a complete car park reconstruction). The design of asphalt road paving is dependent on geotechnical investigation and civil pavement design. Costs listed are indicative only (Ex GST) and provide a 15% contingency allowance.

## POTENTIAL FUNDING PARTNERS

With an estimated total cost of just over **TBC** in recommended reserve improvements, Latrobe City Council will require support from a number of key stakeholders.

Potential funding partners have been identified in the supporting master plan implementation schedule to assist with the scoping and delivery of reserve enhancement recommendations.

# DRAFT

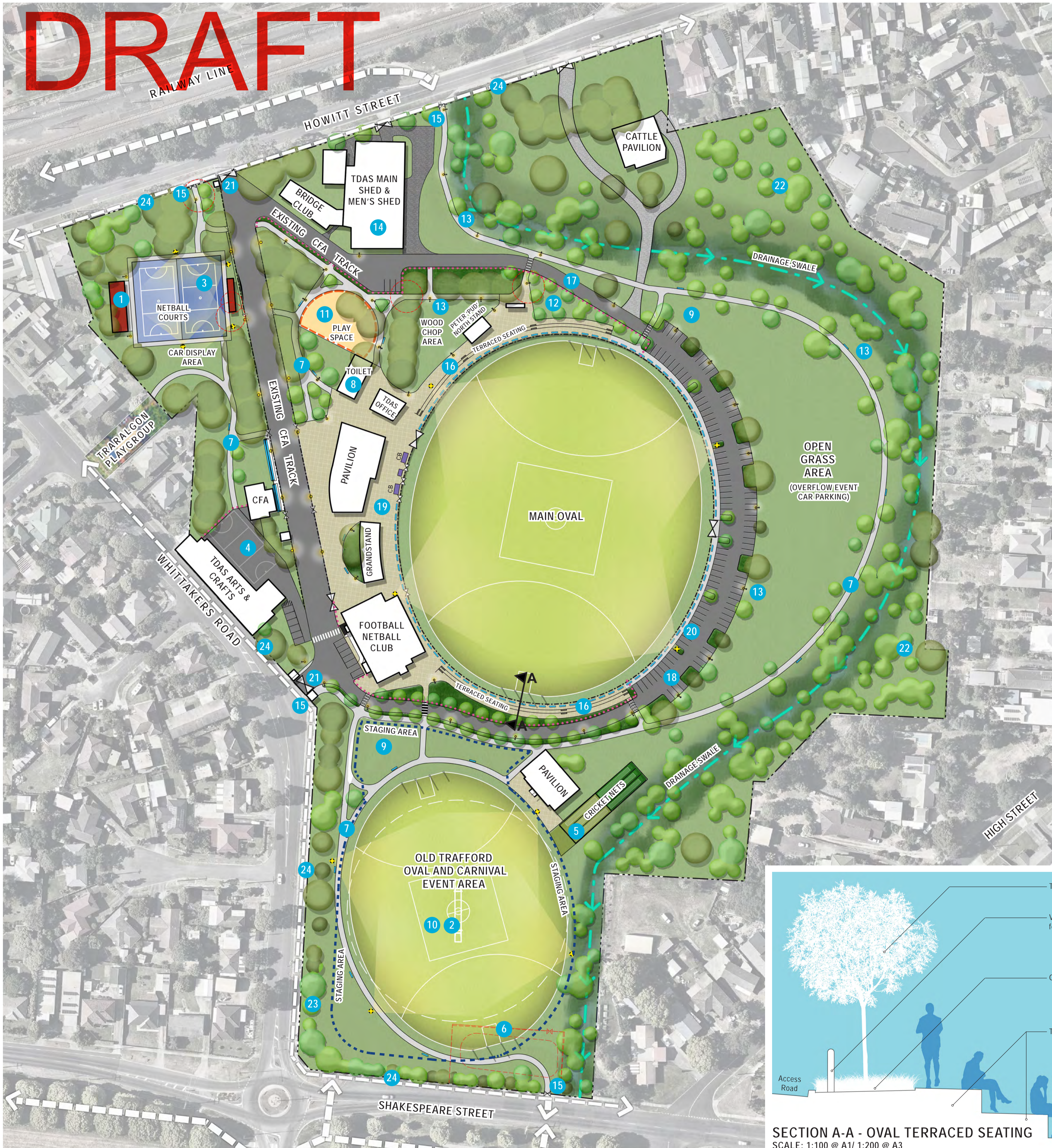

## LEGEND

- Existing Trees
- Proposed Trees
- Asphalt Road Paving
- Proposed Pedestrian Crossing
- Proposed Pathway  
2.5m wide concrete paving
- Existing Gravel Driveway
- Proposed Shared Pedestrian/  
Vehicle Zone
- Proposed Building/ Structure
- Proposed Low Fencing
- Proposed High Chain Mesh Fencing
- Proposed Vehicular Exclusion  
Fencing.
- Proposed Access Gate
- Proposed Seats
- Proposed Lighting
- Existing Site Feature to be  
Demolished
- Existing Pathways

## RECOMMENDATIONS

### SPORTS INFRASTRUCTURE

- 1 Design and construct new local level netball amenities including player change rooms, spectator area, officials and first aid room. Locate on the west side of the existing netball court and design in accordance with Netball Victoria's Netball Court Planning Guide.
- 2 Increase the capacity and playability of Old Trafford Oval for a range of sports training, competition and community events by upgrading and expanding the playing surface, lighting to a minimum of 50 lux and increase power supply.
- 3 Explore opportunities to provide a second compliant netball court to the east of the existing netball court. This will require relocation of the existing light poles due to space restrictions. Alternatively, locate second court south of the existing court aligned east-west.
- 4 Retain asphalt surfacing adjacent Traralgon and District Agricultural Society (TDAS) 'Craft' building for a range of uses including netball warm up and overflow car parking.
- 5 At the end of their useful life, upgrade existing synthetic cricket training nets and consider relocating to facilitate bowlers runups off the oval surface.

### COMMUNITY RECREATION

- 6 Relocate existing BMX track to a more suitable site in Traralgon. This will provide new passive open space opportunities and enable the extension of Old Trafford Oval.
- 7 Expand the shared pathway network within the reserve to provide safe connectivity to facilities. A major connection is recommended between Howitt Street and Shakespeare Street along the existing drainage swale.
- 8 Retain and upgrade existing public toilet facility with unisex / accessible toilets that can support large scale events.
- 9 Provide three-phase electrical power supply to the site to support community event power requirements.
- 10 Ensure the proposed redevelopment of Old Trafford Oval accommodates a 'Staging Area' for the CFA. The surface (oval) needs to be weight bearing and designed to withstand heavy vehicles.
- 11 Support informal recreation opportunities through the provision of an accessible local level public playspace and picnic area between the netball facilities and wood chop area. Playspace design to compliment surrounding environment with no loss of commemorative trees
- 12 Improve visual and social amenity through landscaping, tree planting (for natural shade) and park furniture (bench seating, picnic tables) to support for informal recreation and social events.
- 13 Increase security lighting across site with a focus on the north end of the reserve surrounding the TDAS building, Bridge Club and Men's Shed.
- 14 Retain Agricultural Society, Bridge Club and Men's shed buildings and associated access points and car parking.
- 15 Promote historical significance of site through interpretative and directional signage throughout Reserve in accordance with Council's Signage Guidelines.
- 16 Enhance and promote enjoyable spectator and casual visitor experiences through the provision of terraced seating to nominated sections around the main playing oval.

### TRAFFIC MANAGEMENT AND LANDSCAPING

- 17 Improve access road interface and amenity North of Reserve via additional landscaping and tree planting.
- 18 Upgrade, expand and formalise car parking around the main oval to better manage match day and event traffic. Car parking spaces to be designed around existing tree planting.
- 19 Review site traffic management and car parking requirements and consider a vehicle exclusion zone/pedestrian plaza between Traralgon Football Netball Club change room facilities, grandstand and main social building.
- 20 Improve pedestrian safety surrounding main oval through the separation of vehicles and pedestrians ensuring provision of DDA compliant access.
- 21 Retain and enhance the existing Whittakers Road and Howitt Street Reserve entry points to accommodate match day and community event traffic flow.
- 22 Provide additional tree planting along the eastern boundary to improve aesthetics and shade provision. Consider residential views into the Reserve when determining tree planting species and positioning.
- 23 Improve tree planting along Whittakers Road.
- 24 Replace all reserve perimeter fencing with uniformed fencing to improve overall aesthetics, facilitate site access and manage pedestrian traffic on event days.

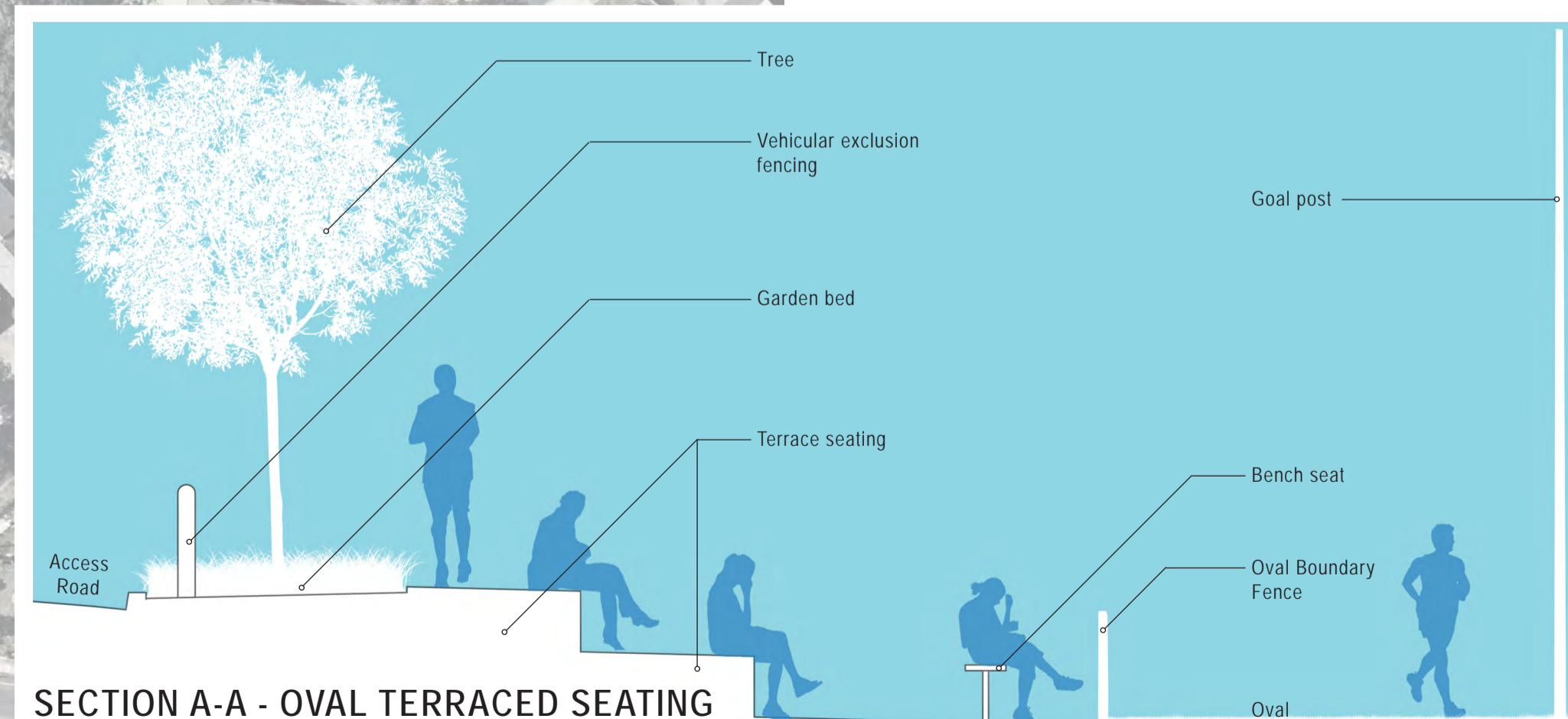

SECTION A-A - OVAL TERRACED SEATING  
SCALE: 1:100 @ A1/ 1:200 @ A3

# IMPLEMENTATION PLAN

Priority	Recommendations	Development principles	Stakeholders	Estimated cost (\$)	Potential funding partners
	<b>Sporting facilities</b>				
High	1. Design and construct new local level netball amenities including player change rooms, spectator area, officials and first aid room. Locate on the west side of the existing netball court and design in accordance with Netball Victoria's Netball Court Planning Guide.	<ul style="list-style-type: none"> <li>• Facility development</li> <li>• Accessibility</li> <li>• Community &amp; social amenity</li> <li>• Sports field provision &amp; suitability</li> </ul>	Council, Netball Victoria, Traralgon Football Netball Club	TBC	Sport and Recreation Victoria, Netball Victoria
High	2. Increase the capacity and playability of Old Trafford Oval for a range of sports training, competition and community events by upgrading and expanding the playing surface, lighting to a minimum of 50 lux and increase power supply.	<ul style="list-style-type: none"> <li>• Facility development</li> <li>• Accessibility</li> <li>• Community &amp; social amenity</li> <li>• Sports field provision &amp; suitability</li> </ul>	Council, Traralgon Recreation Reserve Committee	TBC	Sport and Recreation Victoria, The Latrobe Valley Authority
Medium	3. Explore opportunities to provide a second compliant netball court to the east of the existing netball court. This will require relocation of the existing light poles due to space restrictions. Alternatively, locate second court south of the existing court aligned east-west.	<ul style="list-style-type: none"> <li>• Facility development</li> <li>• Accessibility</li> <li>• Community &amp; social amenity</li> <li>• Sports field provision &amp; suitability</li> </ul>	Council, Netball Victoria, Traralgon Football Netball Club	TBC	Sport and Recreation Victoria, Netball Victoria
Medium	4. Retain asphalt surfacing adjacent Traralgon and District Agricultural Society (TDAS) 'Craft' building for a range of uses including netball warm up and overflow car parking.	<ul style="list-style-type: none"> <li>• Facility development</li> <li>• Accessibility</li> <li>• Community &amp; social amenity</li> </ul>	Council, Traralgon Recreation Reserve Committee	TBC	Council
Low	5. At the end of their useful life, upgrade existing synthetic cricket training nets and consider relocating to facilitate bowlers runups off the oval surface.	<ul style="list-style-type: none"> <li>• Facility development</li> <li>• Sports field provision &amp; suitability</li> </ul>	Council, Ex Students Cricket Club	TBC	Cricket Victoria, Ex Students Cricket Club

Priority	Recommendations	Development principles	Stakeholders	Estimated cost (\$)	Potential funding partners
	<b>Community recreation and event infrastructure</b>				
High	6. Relocate existing BMX track to a more suitable site in Traralgon. This will provide new passive open space opportunities and enable the extension of Old Trafford Oval.	<ul style="list-style-type: none"> <li>Community &amp; social amenity</li> <li>Sports field provision &amp; suitability</li> </ul>	Council	TBC	Council
High	7. Expand the shared pathway network within the reserve to provide safe connectivity to facilities. A major connection is recommended between Howitt Street and Skakespeare Street along the existing drainage swale.	<ul style="list-style-type: none"> <li>Accessibility</li> <li>Community &amp; social amenity</li> </ul>	Council	TBC	Council, The Latrobe Valley Authority
High	8. Retain and upgrade existing public toilet facility with unisex / accessible toilets that can support large scale events.	<ul style="list-style-type: none"> <li>Facility development</li> <li>Accessibility</li> <li>Community &amp; social amenity</li> </ul>	Council, Traralgon Recreation Reserve Committee	TBC	Council
High	9. Provide three-phase electrical power supply to the site to support community event power requirements.	<ul style="list-style-type: none"> <li>Facility development</li> <li>Community &amp; social amenity</li> </ul>	Council, Traralgon Recreation Reserve Committee	TBC	Council, TDAS
Medium	10. Ensure the proposed redevelopment of Old Trafford Oval accommodates a 'Staging Area' for the CFA. The surface (oval) needs to be weight bearing and designed to withstand heavy vehicles.	<ul style="list-style-type: none"> <li>Facility development</li> <li>Accessibility</li> </ul>	Council, Traralgon Urban Fire Brigade	TBC	Council
Medium	11. Support informal recreation opportunities through the provision of an accessible local level public playspace and picnic area between the netball facilities and wood chop area. Playspace design to compliment surrounding environment with no loss of commemorative trees.	<ul style="list-style-type: none"> <li>Facility development</li> <li>Accessibility</li> <li>Community &amp; social amenity</li> </ul>	Council, Traralgon Recreation Reserve Committee	TBC	Council
Medium	12. Improve visual and social amenity through landscaping, tree planting (for natural shade) and park furniture (bench seating, picnic tables) to support for informal recreation and social events.	<ul style="list-style-type: none"> <li>Community &amp; social amenity</li> </ul>	Council, Traralgon Recreation Reserve Committee	TBC	Council

DRAFT

Priority	Recommendations	Development principles	Stakeholders	Estimated cost (\$)	Potential funding partners
	<b>Community recreation and event infrastructure</b>				
Medium	13. Increase security lighting across site with a focus on the north end of the reserve surrounding the TDAS building, Bridge Club and Men's Shed.	<ul style="list-style-type: none"> <li>• Accessibility</li> <li>• Community &amp; social amenity</li> </ul>	Council, Traralgon Recreation Reserve Committee	TBC	Council
Medium	14. Retain Agricultural Society, Bridge Club and Men's shed buildings and associated access points and car parking.	<ul style="list-style-type: none"> <li>• Accessibility</li> <li>• Community &amp; social amenity</li> </ul>	Council, TDAS	TBC	Council, TDAS
Low	15. Promote historical significance of site through interpretative and directional signage throughout Reserve in accordance with Council's Signage Guidelines.	<ul style="list-style-type: none"> <li>• Community &amp; social amenity</li> </ul>	Council, Traralgon Recreation Reserve Committee	TBC	Council
Low	16. Enhance and promote enjoyable spectator and casual visitor experiences through the provision of terraced seating to nominated sections around the main playing oval.	<ul style="list-style-type: none"> <li>• Facility development</li> <li>• Accessibility</li> <li>• Community &amp; social amenity</li> </ul>	Council, Traralgon Recreation Reserve Committee	TBC	Council

DRAFT

Priority	Recommendations	Development principles	Stakeholders	Estimated cost (\$)	Potential funding partners
	<b>Traffic management and landscaping</b>				
High	17. Review site traffic management and car parking requirements and consider a vehicle exclusion zone/pedestrian plaza between Traralgon Football Netball Club change room facilities, grandstand and main social building.	<ul style="list-style-type: none"> <li>Accessibility</li> <li>Community &amp; social amenity</li> </ul>	Council, Traralgon Football Netball Club	TBC	Council
High	18. Replace all reserve perimeter fencing with uniformed fencing to improve overall aesthetics, facilitate site access and manage pedestrian traffic on event days.	<ul style="list-style-type: none"> <li>Accessibility</li> <li>Community &amp; social amenity</li> </ul>	Council, Traralgon Recreation Reserve Committee	TBC	Council
High	19. Retain and enhance the existing Whittakers Road and Howitt Street Reserve entry points to accommodate match day and community event traffic flow.	<ul style="list-style-type: none"> <li>Accessibility</li> </ul>	Council, Traralgon Recreation Reserve Committee	TBC	Council
Medium	20. Upgrade, expand and formalise car parking around the main oval to better manage match day and event traffic. Car parking spaces to be designed around existing tree planting.	<ul style="list-style-type: none"> <li>Accessibility</li> <li>Community &amp; social amenity</li> </ul>	Council, Traralgon Recreation Reserve Committee	TBC	Council
Medium	21. Improve pedestrian safety surrounding main oval through the separation of vehicles and pedestrians ensuring provision of DDA compliant access.	<ul style="list-style-type: none"> <li>Accessibility</li> <li>Community &amp; social amenity</li> </ul>	Council, Traralgon Recreation Reserve Committee	TBC	Council
Low	22. Improve access road interface and amenity North of Reserve via additional landscaping and tree planting.	<ul style="list-style-type: none"> <li>Community &amp; social amenity</li> </ul>	Council	TBC	Council
Low	23. Provide additional tree planting along the eastern boundary to improve aesthetics and shade provision. Consider residential views into the Reserve when determining tree planting species and positioning.	<ul style="list-style-type: none"> <li>Community &amp; social amenity</li> </ul>	Council	TBC	Council
Low	24. Improve tree planting along Whittakers Road.	<ul style="list-style-type: none"> <li>Community &amp; social amenity</li> </ul>	Council	TBC	Council

DRAFT

# RESERVE IMPROVEMENTS COST SUMMARY

Number of <b>high priority</b> reserve improvement recommendations	9
Estimated opinion of probable cost for high priority reserve improvement recommendations	TBC
Number of <b>medium priority</b> reserve improvement recommendations	9
Estimated opinion of probable cost for medium priority reserve improvement recommendations	TBC
Number of <b>low priority</b> reserve improvement recommendations	6
Estimated opinion of probable cost for low priority reserve improvement recommendations	TBC
<b>TOTAL NUMBER OF RESERVE IMPROVEMENT RECOMMENDATIONS</b>	<b>24</b>
<b>TOTAL ESTIMATED OPINION OF PROBABLE COSTS FOR ALL RESERVE IMPROVEMENT RECOMMENDATIONS</b>	<b>TBC</b>

**DRAFT**

the deck