

## B TYPE KERBS

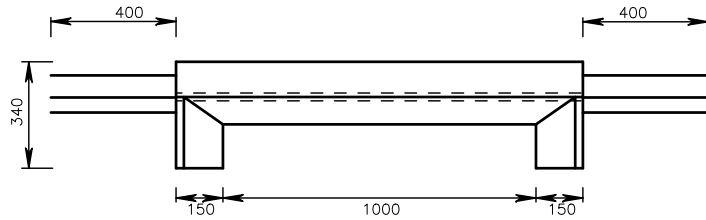

ELEVATION

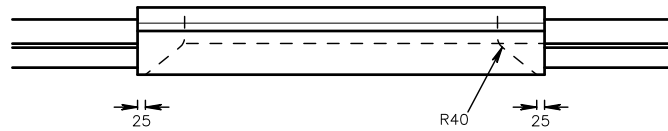

PLAN

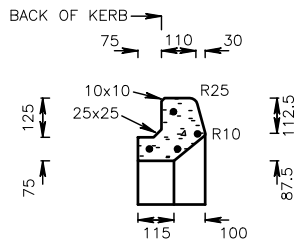

SECTION

## SM TYPE KERBS

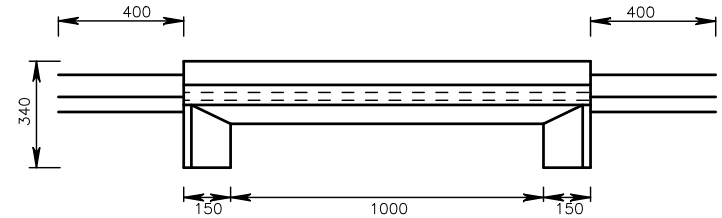

ELEVATION

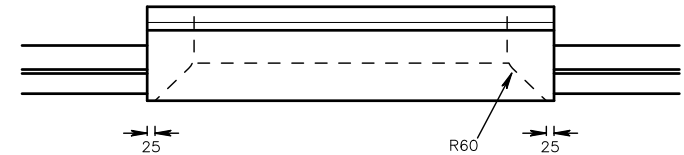

PLAN

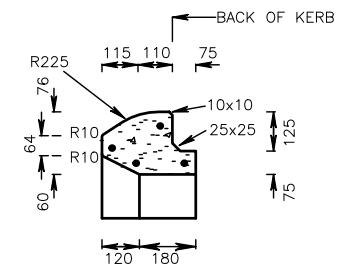

SECTION

## NOTES

1. REINFORCEMENT SIZE AND LOCATION MUST BE ABLE TO SUPPORT A PROOF LOAD OF 100 kN WITHOUT PERMANENT DEFORMATION OR DAMAGE.
2. CONCRETE COMPRESSIVE STRENGTH MUST BE A MINIMUM OF 40 MPa AT 28 DAYS.
3. CONCRETE COVER TO REINFORCEMENT MUST BE A MINIMUM OF 25 mm.



### GENERAL NOTES / CROSS REFERENCES

1. All dimension in mm unless noted otherwise.
2. LCC 101 KERBS

File name: LCC 203 Lintels.pro

# Latrobe City

## LINTELS

CITY AUTHORISATION

VERSION/  
DATE OF PLOT 1/4/2015

SCALE



DWG No.

LCC 203

SHEET NO. 1 OF 1